

# Burnham Beeches

Use this map to explore this fantastic nature reserve but please leave all natural things - flowers, fungi, wood etc. - where you find them, and please use the bins provided or take your rubbish home.

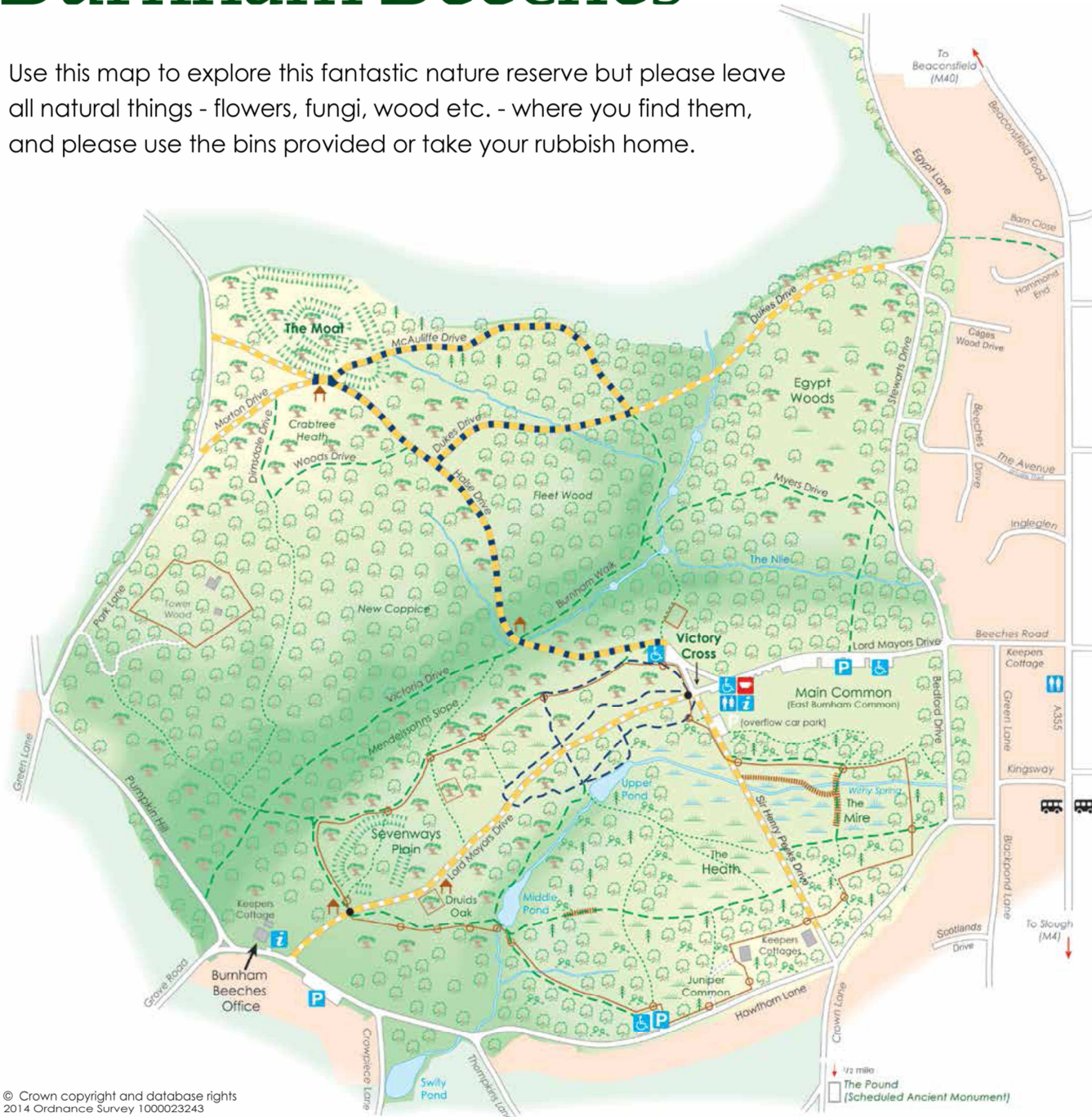

## Roads open to:

- road
- road closed to all vehicles
- blue badge access available on request
- easy access gate & cycle grid

## Paths only for:

- track
- main footpath
- minor path
- easy access path
- fence
- boardwalk
- gate

## Habitats and features

- ancient woodland
- ancient pollards
- young woodland
- dry heath
- wet heath/mire
- open grassland
- stream
- swallow hole
- Scheduled Ancient Monument

## Facilities

- car park (pay & display weekends and public holidays)
- blue badge parking
- Beeches Café
- toilets
- information point
- shelter

## PSPOs map

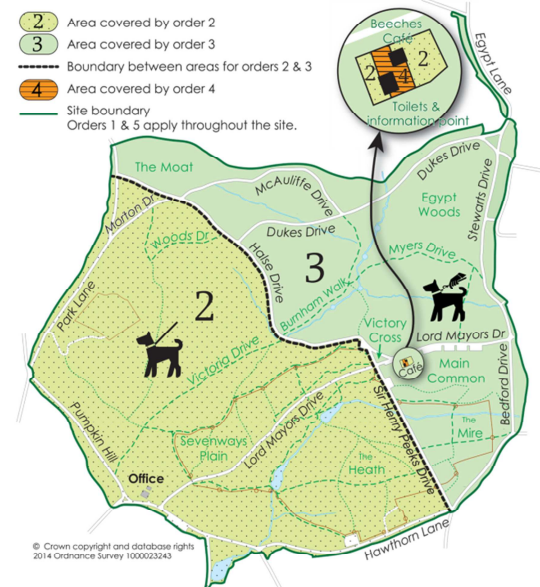

Dog walkers are welcome but must: remove all faeces their dog drops; bring no more than 4 dogs onto the site at one time; observe the exclusion area; put their dog on a lead when required and/or asked to do so by a Ranger (as appropriate according to the Public Spaces Protection Orders). Please see site maps, the walking your dog at Burnham Beeches leaflet or look on-line for more information.