

View 28: Approach route 4 Great Tower Street (new selected view) - Proposed Clusters

ED-HTB22

Proposed

- 6.252 The Proposed City Cluster would form a collective backdrop to the church, but the spire would retain its sky space and would remain the dominant feature in this view.
- 6.253 The Proposed City Cluster as a consolidated form would be read as a distinct backdrop layer of high density and scale, acknowledging its city status. This would increase the sense of enclosure of this view and add a dynamic juxtaposition, characteristics of the City Cluster. The effect would be **neutral**.



View 29: Approach route 4 Great Tower Street (new selected view) - Existing

Existing

6.254 This view is taken from Great Tower Street, looking towards the WHS. All Hallows by the Tower is in the centre of the view. Both the church and the White Tower are partially concealed by the trees that surround them. Minster Court, a post-modern commercial development, is on the left side of the view. Part of the neighbouring development fronting Byward Street is also visible. On the right side of the view, developments of a finer grain line the southern side of Great Tower Street.



View 29: Approach route 4 Great Tower Street (new selected view) - Future Baseline

Future baseline

6.255 No consented schemes are seen in this view.

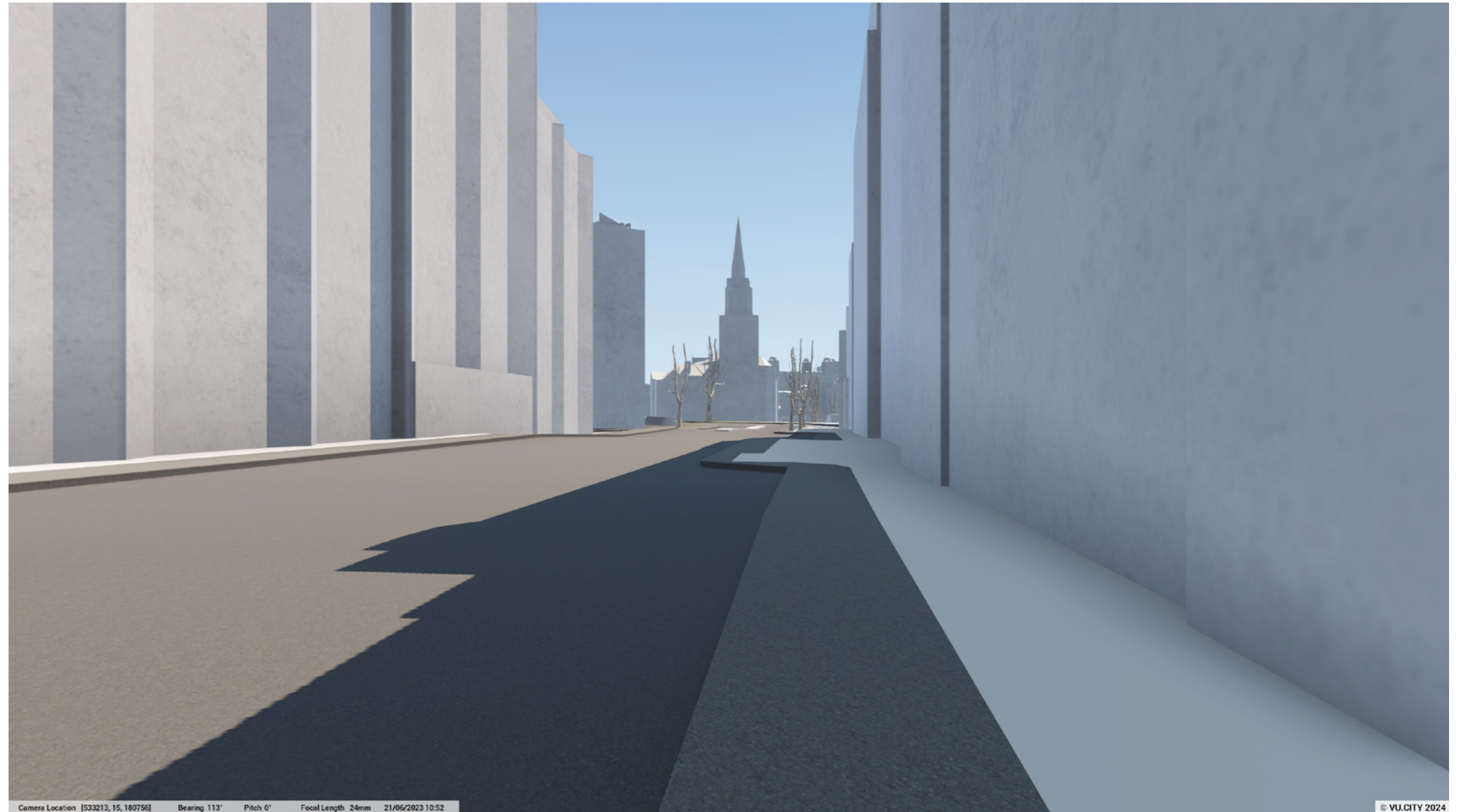

View 29: Approach route 4 Great Tower Street (new selected view) - Proposed Clusters

Proposed

6.256 The Proposed Clusters are not visible in this view
There is **no effect**.

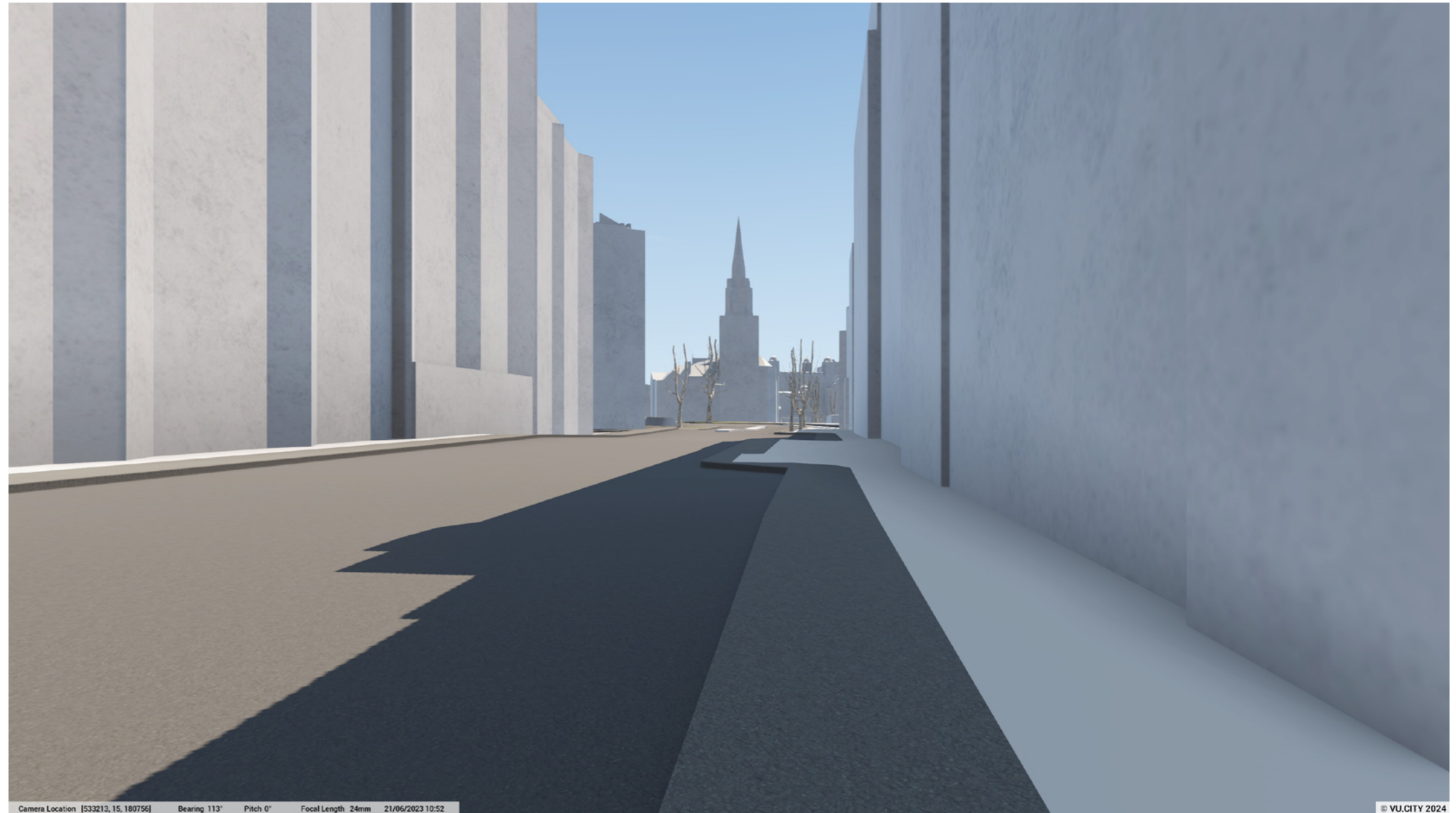

View 30: Representative Viewpoint 5 Main entrance of the Tower (looking away from TOL) - Existing

Existing

- 6.257 This view is taken from the main entrance to the Tower (since the 13th century), on a bridge between the Middle Tower and the Byward Tower, looking towards the City Cluster. The bridge and part of the Middle Tower are in the foreground, and Tower Place West appears behind them. The Tower of London Setting Study notes that *'the view clearly illustrates the defences of the Tower, with the Outer Curtain Wall and the Moat dominating the view'*.
- 6.258 The Old London Port Authority building is the dominant feature in the middle ground, alongside other mid-rise development along Byward Street and Trinity Square.
- 6.259 The existing City Cluster is in the background stepping up from 30 St Marys Axe to 22 Bishopsgate. To the right, large commercial developments appear, such as One American Square. There is a clear contrast between new and historic developments in this view.
- 6.260 On the significance of this view, the Tower of London Setting Study states: *'The dominance of the Tower's defences within this view also strongly reflects the military architecture of the 13th century, when the Outer Curtain Wall was built and the moat was expanded to 50m wide.'*





View 30: Representative Viewpoint 5 Main entrance of the Tower (looking away from TOL) - Future Baseline

Future baseline

6.261 50 Fenchurch Street is seen in the foreground of the City Cluster. One Undershaft and 100 Leadenhall Street add two of the tallest buildings to the City Cluster.



View 30: Representative Viewpoint 5 Main entrance of the Tower (looking away from TOL) - Proposed Clusters

Proposed

- 6.262 The Proposed City Cluster would read as a defined grouping with a clear eastern edge in this view that would maintain the sky space around the lantern of the Old London Port Authority building.
- 6.263 The consolidation of forms would include the primary crest furthest away in this view, stepping down through secondary crests closer to the viewer. This proposed consolidation would have a **beneficial** effect on the City Cluster form, and a **neutral** effect on the view overall.

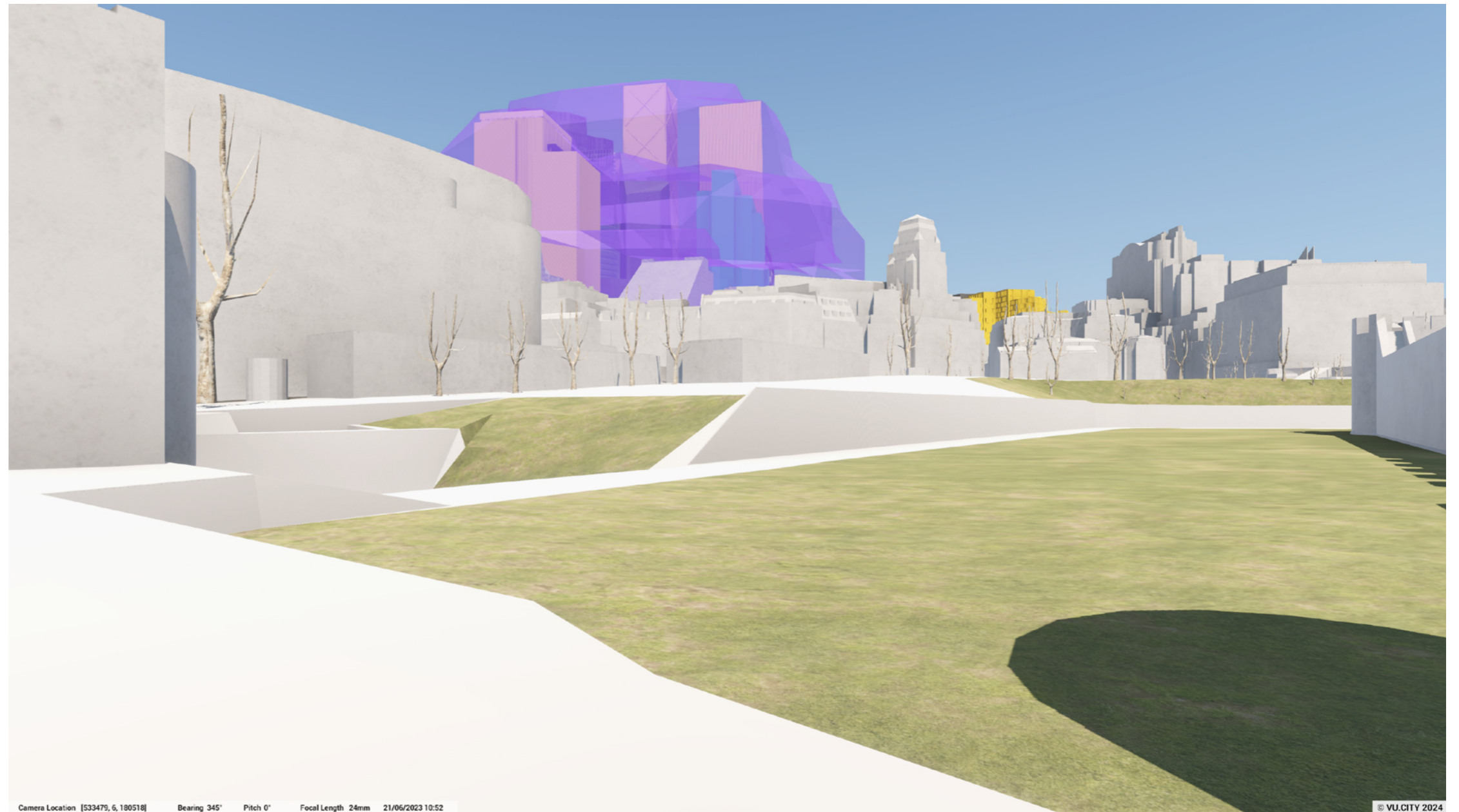

View 31: Representative Viewpoint 1 Tower Green, Inner Ward (new selected viewpoint) - Existing

Existing

- 6.264 This view is taken from Tower Green, in the Inner Ward of the Tower. The Tower of London Setting Study notes that there *'is a range of views from within the Inner Ward'*, and that views from the former scaffold site are experienced *'by a large number of people daily'*. The Chapel Royal of St Peter ad Vincula is on the right side. In front of these buildings is Tower Green, which is dotted with mature London Plane trees.
- 6.265 The Tower of London Setting Study describes the significance of this view as follows: *'Views from the Inner Ward illustrate the living tradition of the Tower, its rich ceremonial life and unique sense of place set apart from the modern City outside its walls. They also illustrate the relationship between and scale of the individually outstanding palace buildings of the Inner Ward, including the White Tower, the Bloody Tower, the Queen's House and the Fusiliers' Museum. Tower Green as the site of the execution of three English queens, Anne Boleyn, Catherine Howard and Jane Grey, is significant as a setting for key historical events in European history.'*
- 6.266 The very top of 22 Bishopsgate is seen above the Chapel Royal of St Peter ad Vincula and the corner of 20 Fenchurch Street is at the junction of the Chapel Royal of St Peter ad Vincula and the Chaplain's House.



View 31: Representative Viewpoint 1 Tower Green, Inner Ward (new selected viewpoint) - Future Baseline

Future baseline

6.267 One Undershaft and a very small amount of 50 Fenchurch Street would also appear above the Chapel Royal of St Peter ad Vincula.





View 31: Representative Viewpoint 1 Tower Green, Inner Ward (new selected viewpoint) - Proposed Clusters

Proposed

6.268 The Proposed City Cluster would allow for a limited amount of additional visibility above the roofline of the Chapel Royal of St Peter ad Vincula. This would be a **neutral** effect over the future baseline. Proposals for new tall buildings on relevant sites within the Proposed City Cluster would need to be carefully scaled and designed to respond to the sensitivity of this foreground.



View 32: Representative Viewpoint 1 Tower Green, Inner Ward (new selected viewpoint) - Existing

Existing

6.269 This view is also taken from Tower Green in the Inner Ward. Southeast from view 23 at the former scaffold site. As such, it takes in more of the Chapel Royal of St Peter ad Vincula. Part of the City Cluster appears behind the Chapel, including 22 Bishopsgate, The Leadenhall Building and 52 Lime Street. The roof of 20 Fenchurch Street appears behind the Chaplain's House.





View 32: Representative Viewpoint 1 Tower Green, Inner Ward (new selected viewpoint) - Future Baseline

Future baseline

6.270 50 Fenchurch Street would appear behind the bell tower of the Chapel. One Undershaft and 100 Leadenhall Street appear prominently to the east.



View 32: Representative Viewpoint 1 Tower Green, Inner Ward (new selected viewpoint) - Proposed Clusters

Proposed

6.271 The Proposed City Cluster, shown in purple, would draw together 20 Fenchurch Street, 50 Fenchurch Street and the primary crest of the Proposed City Cluster. This would contribute to the understanding of the three dimensionality of the City Cluster as a whole. This would, however, result in a greater backdrop to the Chapel Royal of St Peter ad Vincula. This would be a **neutral** effect over the future baseline. Proposals for new tall buildings on relevant sites within the Proposed City Cluster would need to be carefully scaled and designed to respond to the sensitivity of this foreground.



View 33: Representative Viewpoint 1 Tower Green, Inner Ward (new selected viewpoint) - Existing

Existing

6.272 This view is also taken from the Inner Ward, southeast from view 24. As such, it takes in more of the Chapel Royal of St Peter ad Vincula. On the right side of the view, part of the Waterloo Barracks is also visible. Tower Green is in the foreground and is dotted with mature London plane trees. The existing City Cluster is more visible in this view, including 30 St Mary Axe, as well as those seen in view 24. This is a less enclosed view than those from the scaffold site. The contrast between new and historic developments is more apparent in this view.



View 33: Representative Viewpoint 1 Tower Green, Inner Ward (new selected viewpoint) - Future Baseline

Future baseline

6.273 More of the emerging City Cluster is visible; 55, 70 and 85 Gracechurch Street are seen beyond 20 Fenchurch Street and the bell tower of the Chapel. 50 Fenchurch Street, One Undershaft and 100 Leadenhall Street would add to the backdrop of the Chapel roof.



View 33: Representative Viewpoint 1 Tower Green, Inner Ward (new selected viewpoint) - Proposed Clusters

Proposed

6.274 The Proposed City Cluster, shown in purple, would draw together the elements of the existing and emerging City Cluster to create a more coherent overall form. From here the three distinct crests of the Proposed City Cluster would be appreciable. It would create a denser backdrop to the Chapel. The effect would be **neutral**. Proposals for new tall buildings on relevant sites within the Proposed City Cluster would need to be carefully scaled and designed to respond to the sensitivity of this foreground.



View 34: Representative Viewpoint 1 Tower Green, Inner Ward (new selected viewpoint) - Existing

Existing

6.275 This view is taken from the Inner Ward, outside the White Tower, further east from view 25. It looks towards the City, and the Cluster appears in the background. In the foreground is the former scaffold site and Tower Green. Buildings within the ToL also appear in the foreground, including the Chaplain's House, the Chapel Royal of St Peter ad Vincula, and Waterloo Barracks. The Leadenhall Building is visible in the background beyond the bell tower of the St Peter ad Vincula.





View 34: Representative Viewpoint 1 Tower Green, Inner Ward (new selected viewpoint) - Future Baseline

Future baseline

6.276 55 Gracechurch Street is seen stepping down from 20 Fenchurch Street. 50 Fenchurch Street and One Undershaft are either side of 22 Bishopsgate.



View 34: Representative Viewpoint 1 Tower Green, Inner Ward (new selected viewpoint) - Proposed Clusters

Proposed

6.277 The Proposed Cluster, shown in purple, would be seen extending to the east and west from this viewpoint. To the west it connects to 20 Fenchurch Street (not seen in this view) and to the east, the form steps down to create a defined edge with clear sky space around. In addition to the future baseline, the Cluster would have more of a quantitative effect which would be **neutral**. Proposals for new tall buildings on relevant sites within the Proposed City Cluster would need to be carefully scaled and designed to respond to the sensitivity of this foreground.



View 35: Representative Viewpoint 1 Tower Green, Inner Ward (new selected viewpoint) - Existing

Existing

6.278 This view is taken from the Inner Ward, outside the White Tower, further south from view 26 looking towards the City. In the foreground, several buildings within the Tower appear, including Beauchamp Tower, the Chaplain's House, the Chapel Royal of St Peter ad Vincula and Waterloo Barracks. Tower Green and the former scaffold site also appear in the foreground. The Cluster appears in the background, behind the Chapel and its bell tower.

