

# Make your own Amphitheatre collage picture

In 1988, archaeologists working on the site of the new Guildhall Art Gallery found part of London's Roman Amphitheatre. Almost 2000 years old, the remains are preserved in the basement of the Gallery.

Create your own picture of London's amphitheatre using collage. Firstly, draw the amphitheatre. Then add some pictures you have cut from newspapers, magazines or leaflets, or drawn on a separate piece of paper, to finish the picture.

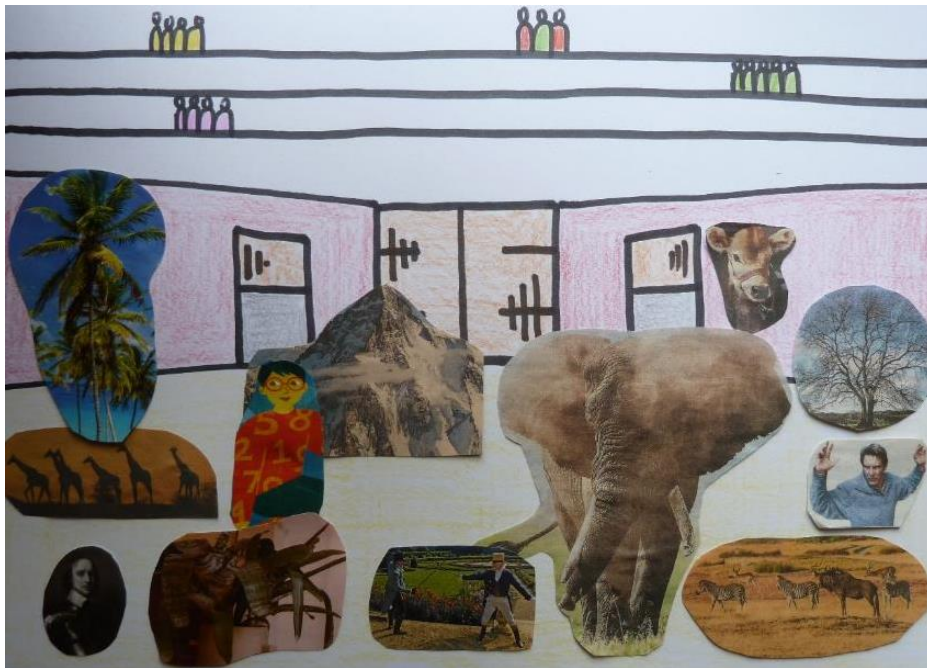

To make your Amphitheatre collage you will need:

- A4 piece of paper or card
- A stick of child friendly glue
- Colouring pencils or pens
- Pictures of animals, people, plants and landscapes cut from newspapers, magazines and leaflets (nothing too big and just cut very roughly around the images).

Don't worry if you can't find any – you could always draw some pictures on a separate piece of paper and cut them out.

# Make your own Amphitheatre collage picture

## Steps:

1. With your paper placed in landscape, draw a rectangle. This will be the entrance.

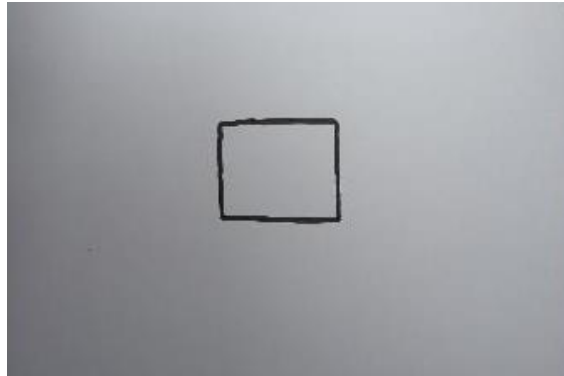

2. Draw a line down the centre to make two gates. Add hinges to each side and draw some vertical lines to make it look like wood.

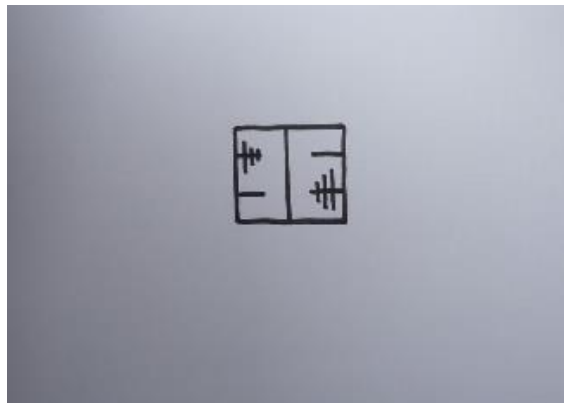

3. Draw the walls of the arena.

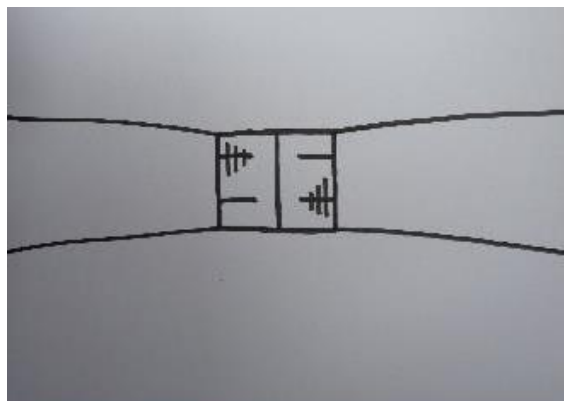

# Make your own Amphitheatre collage picture

4. Draw two small entrances on either side of the main gate. With trap doors that slid up and down, these rooms were probably used to keep wild animals in.



5. Draw some rows of seats above the entrance.

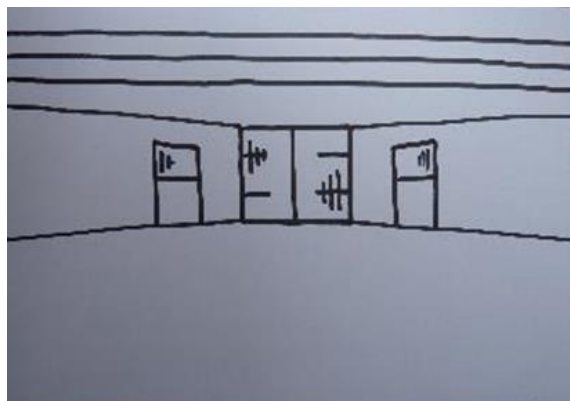

6. Draw some people in the seats.

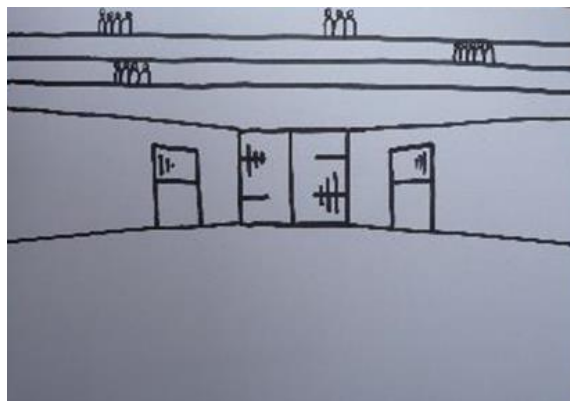

# Make your own Amphitheatre collage picture

7. Colour the gate and trap doors brown, the arena wall red and the sand covering the floor yellow.

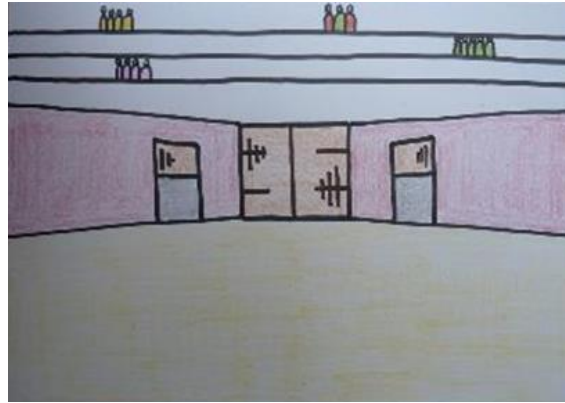

8. Add the animals, people, plants and landscapes you have cut out or drawn to finish your picture of the amphitheatre.

